

# AMARCO

American Mat & Rubber Company

## Entrance Mats & Gratings

### ATF 1005 Bronze Recessed Frame

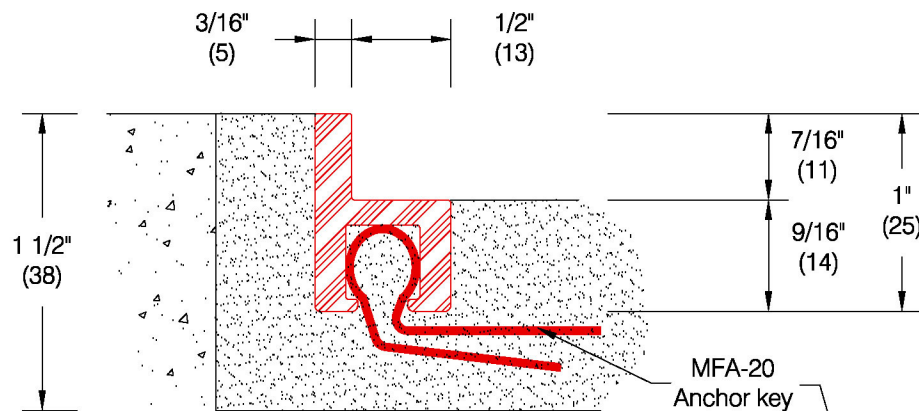

#### Features:

- Use for AI-Track or other 3/8" (10) through 5/8" (16) thick mats
- Extruded architectural bronze alloy 385
- Stock length: 12'-0" (3658)
- Weight: 1.0 lbs / lf

#### Installation Options:

- Recessed, cast in place

#### Standard Finishes:

- Mill Finish #405

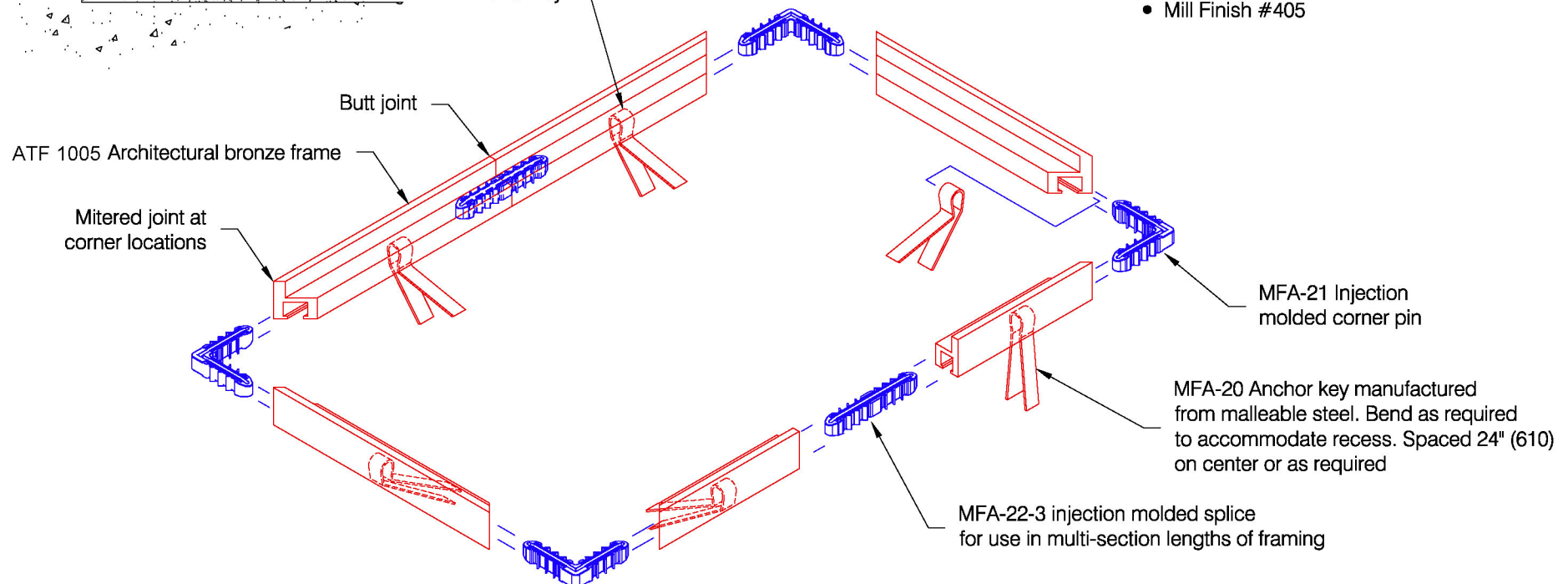

Amarco reserves the right to discontinue a design or modify an existing design without prior notice

Customer :

Project :

Architect :

Sales Rep :

ED.2.0a